

Seam Ripper Kits Assembly Instruction

Required Accessories

- 7mm, Pen Mandrel
- 8mm tubes
- 8mm Drill Bit
- 8mm Barrel Trimmer
- 2pc. Bushings Set
- 2 part glue, epoxy or Insta-cure (cyanoacrylate).



Diagram A - Parts List Single Blade

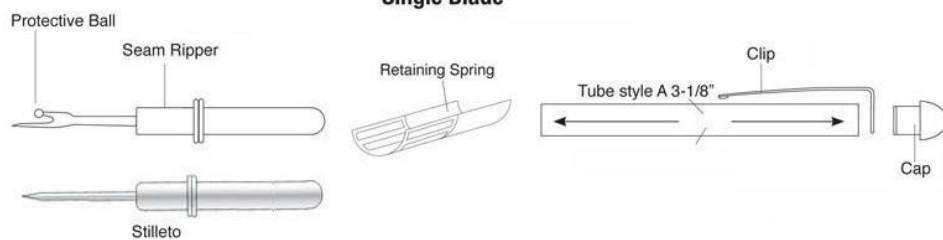

Preparing the Blank

- Prepare and cut a blank of 3/4" or larger, to the length of the brass tube (add 1/16" for trimming)
- Drill a 8mm hole through the center of the blank.
- Spread glue over the tube, insert into blank with a twisting motion to spread the glue evenly inside.
- Center the tube inside the blank.
- When glue is dry. Trim the ends of the blank flush to the tube.

Diagram B - Turning the Blank

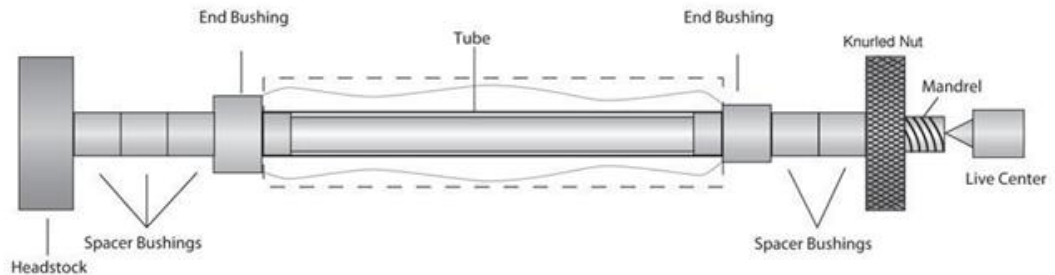

Turning the Blank

- Place the bushings and blank on the mandrel according to Diagram B.
- Use the end bushing on the ends.
- Thread on the knurled nut and hand tighten to hold all items in place.
- Slide the tailstock to the mandrel shaft, (do not overtighten, it could damage the mandrel) lock in place.
- Turn the handle ends down, flush with the bushings using the lathe tools, gradually increasing the grades of sand paper.
- Finish the wood with friction polish or use any project finish of your choice.

Assembly

- Place the clip over the extension of the cap. Press this assembly into the upper end of the handle with smaller diameter.
- Squeeze the retaining spring to a small round circle (DO NOT CREASE) and insert into opening at the end(s). Push in, flush to the surface.
- Slide the seam ripper assembly in and out with both ends to assure a secure fit.
- If spring does not hold in properly (i.e. the spring slides into the tube), Take a Q-tip and dip into CA glue insert the spring and allow the CA to dry. The spring should now operate properly.
- When not in use, reverse the ripper assembly to safely store the blade(s).

Bushing

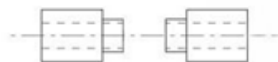

Seam Ripper – Double

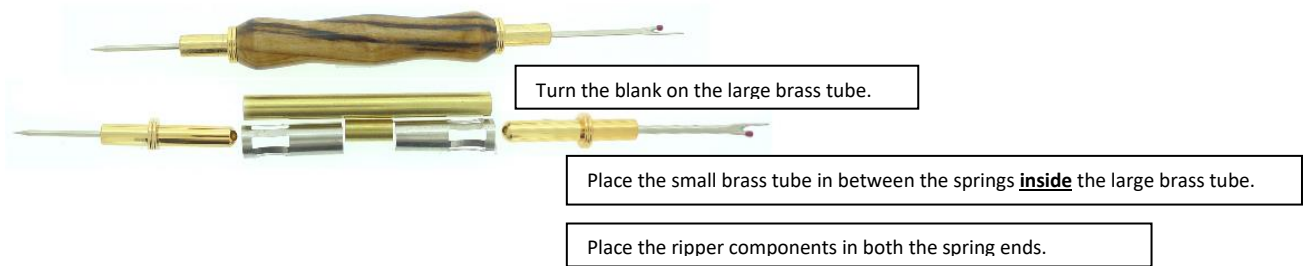

Seam Ripper – Single

